

# RNA/RNB precision shunts

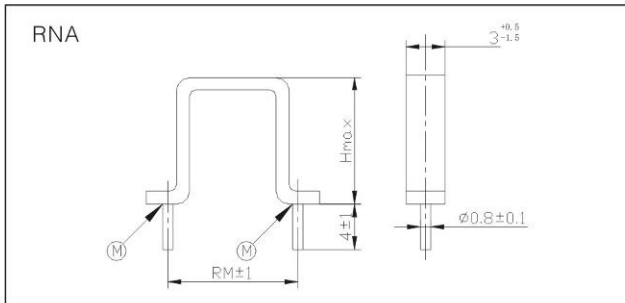

## Construction(mm)



## Dimensions(mm)

Type	Power rating	H	RM
RNA-10-A	0.5W	6.5	10
RNA-10-B	1.0W	10.5	10
RNA-10-C	1.5W	17	10
RNA-15-A	1.0W	8	15
RNA-15-B	1.5W	14.5	15
RNA-20-B	1.5W	12	20

## Construction(mm)

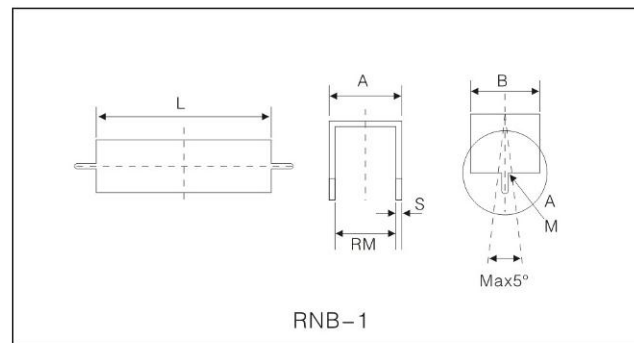
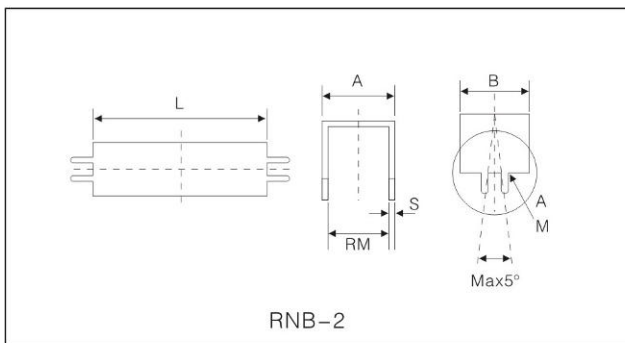

Note: M is the resistance test point, L, A, B and S are specifically determined by the material, resistance and power of the resistor, RM is 5 to 20 in 5mm increments.

## Performance

Test Item	Specifications	Test Methods
Short-term overload	$\Delta R \leq \pm ( 1\%R \pm 0.05 \Omega )$	$\sqrt{5PR}$ 5s
Solderability	The solder wets the lead and can flow freely, and the tin area on the lead is more than 95%	235°C ± 5°C , 2s ± 0.5s
Temperature Coefficient	± 100 (10 <sup>-6</sup> /K)	GB/T 5729-2003 Article 4.8
Long-term life	$\Delta R \leq \pm ( 5\%R \pm 0.1 \Omega )$ Insulation resistance ≥ 1 GΩ	1000h , 1.5h Power on, 0.5h Power off
Maximum Operating Temperature	≤ 70°C	